



Where
inspirational encounters
originate

SOFITEL LEGEND THE GRAND AMSTERDAM

OUDEZIJD'S VOORBURG WAL 197
1012EX - AMSTERDAM - THE NETHERLANDS
TEL. +31 (0)20 555 3 339
MEETINGS.THEGRAND@SOFITEL.COM
WWW.SOFITEL-LEGEND-THEGRAND.COM



Welcome

Sofitel Legend The Grand Amsterdam is the perfect location for discrete board meetings and lavish banquets and from conferencing events to weddings. The Grand provides banqueting facilities in one of the most sought-after properties in the city centre of Amsterdam; offering premier conference facilities and the Sofitel's Meetings concept, which combines modern technology with excellent service and facilities.

Former City Hall

The Grand boasts nineteen meeting rooms and banqueting halls in total, covering 1400 m2 (15.070 ft). Five of these rooms are listed as historical monuments and were taken into use when The Grand formerly served as city hall of Amsterdam: the Council Chamber, the Burgomaster and Aldermans Chamber, the St. Cecilia and the beautiful First Class Marriage Chamber. These historic rooms boast natural daylight, canal or garden view and all have a different magnifiquie story.

Princenhof

The Princenhof, once functioning as accommodation for, amongst others, Prince William of Orange and the French Queen Maria de Medici, holds fourteen contemporary meeting rooms, all equipped with modern audio-visual facilities. It is the perfect venue for private meetings and conferencing events.



A *Legendary* Experience

Sofitel Legend The Grand Amsterdam holds a distinguished place in hospitality as one of only six Sofitel Legend hotels worldwide. This exclusive status highlights our rich heritage, impeccable service, and commitment to creating memorable experiences. Originally two convents, then a royal residence, later the headquarters of the admiralty of Amsterdam, and eventually Amsterdam's city hall, The Grand's storied past is interwoven into every corner of the property.

Our unique historical venues, such as the former Council Chamber and the magnificent Marriage Chamber, blend timeless elegance with modern sophistication. Whether hosting grand celebrations, intimate gatherings, or prestigious corporate events, these iconic spaces offer an unparalleled setting steeped in history.

Step into a world where history meets luxury, and let us turn your event into a truly legendary experience.



Marriage Chamber

Facilities

178 ROOMS, INCLUDING 52
SUITES
BUTLER SERVICE IN OUR 30
SPACIOUS SUITES FROM
PRESTIGE SUITES AND
ABOVE

19 MEETING ROOMS
INCLUDING
5 HISTORICAL ROOMS

2 RESTAURANTS & 3 BARS

PRIVATE DINING

SOFITEL SPA

SOFITEL FITNESS

VALET PARKING

COMPLIMENTARY WI-FI



Tailor made banqueting

Dedicated to your event, the Events team will assist you in planning your event to the smallest details, to ensure a seamless service and stress-free experience.

Whether you are organising a board meeting or a private dinner, the Events team will plan your event into detail and work closely together with the Executive Chef of The Grand to not only provide you with the best accommodation and facilities, but also with a culinary menu that suits your wishes and preferences.



Council Chamber

Location and access

The superb downtown location of The Grand is within walking distance of most major landmarks, such as the Royal Palace, Van Gogh Museum, Anne Frank House and the H'Art Museum. Amsterdam Schiphol Airport (AMS) is 30 minutes by car and Amsterdam Central Station (CS) is within 10 minutes walking distance. A detailed description for travelling by car is available on request.

Main Building
Ground Floor

- 1. Entrance
- 2. Restaurant Bridges
- 3. Bridges, Private Dining
- 4. Bridges, Chef's Table
- 5. Oriole Garden Bistro
- 6. The Flying Dutchman



Historical Meeting Rooms
First Floor

- 8. Aldermans Chamber
- 9. St. Cecilia Chamber
- 10. Burgomaster Chamber
- 11. Marriage Chamber
- 12. Council Chamber
- 13. Balcony
- 14. Garden Terrace
- 15. Courtyard

Princenhof Meeting & Convention Centre

Ground Floor	First Floor	Second Floor
16. Grand Duke	19. King	24. Earl
17. Grand Boardroom	20. Queen	25. Count
18. Admiralty	21. Princess	26. Baron
	22. Prince I	27. Marquis
	23. Prince II	28. Lord

Other

-  . Elevator
-  . Toilets
- 29. Cloakroom

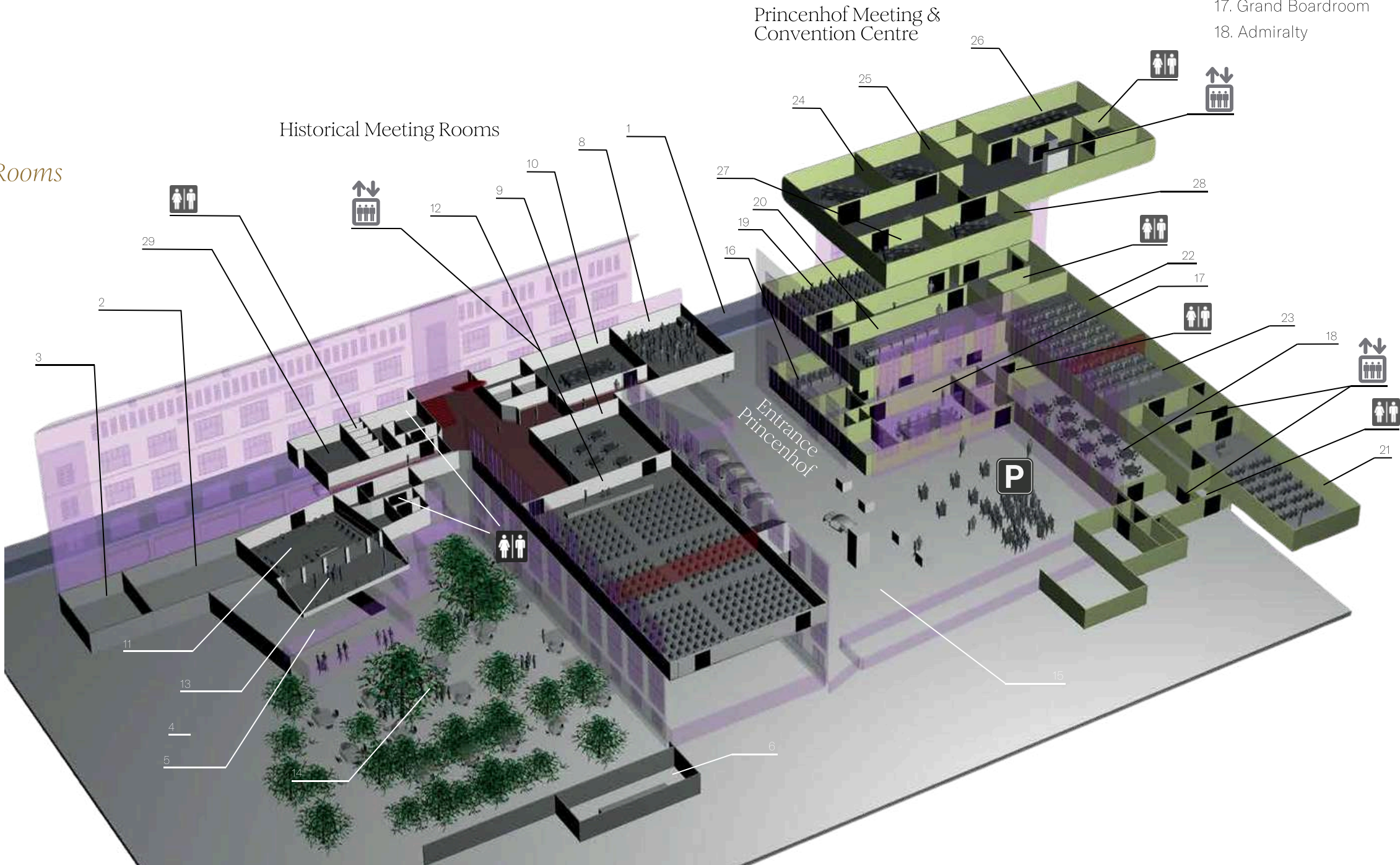

Capacity *Meetings Rooms*

All meeting rooms have air-conditioning / air-cooling, no pillars, and natural daylight

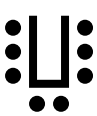
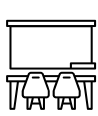
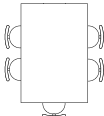

	L	W	H	M²	Ft²	Theatre	Cabaret / Crescent PHS (5 pax / table)	Cabaret / Crescent HS (6-8 pax / table)	Classroom	Square	U-Shape	Boardroom	Banquet	Cocktail
Council Chamber	21.7	13.6	4.7	295	3175	320	-	152	140	-	-	-	200	300
* Council Chamber I	13.6	13.0	4.7	177	1905	200	-	88	72	48	36	36	110	175
* Council Chamber II	14.0	8.7	4.2	122	1313	120	-	64	45	32	23	24	90	125
St. Cecilia Chamber	8.0	7.5	5.0	60	645	50	-	21	27	32	24	20	40	60
Aldermans Chamber	8.1	7.0	3.0	57	613	40	-	21	24	24	24	20	40	60
Burgomaster Chamber	8.2	5.3	3.0	43	462	30	-	-	18	-	-	20	30	40
Marriage Chamber	8.0	6.4	3.2	51	548	45	-	-	-	-	-	20	20	40
* Balcony	8.0	6.4	3.2	51	548	-	-	-	-	-	-	-	-	35
Admiralty	19.0	7.6	3.7	144	1550	110	56	-	-	-	-	-	100	150
Grand Boardroom	9.7	5.8	4.2	56	602	-	-	-	-	-	-	18	-	-
Grand Duke	6.7	5.9	3.6	39	419	30	14	-	12	16	12	12	20	30
Prince	19.4	8.0	3.3	155	1668	150	75	-	72	54	46	40	80	150
* Prince I	11.4	8.0	3.3	91	979	100	45	-	45	36	32	30	50	90
* Prince II	8.0	8.0	3.3	64	688	50	30	-	27	24	16	14	30	60
Queen	13.8	6.2	3.2	85	914	80	30	-	30	26	32	28	40	100
King	15.2	6.2	3.8	94	1011	80	30	-	30	26	32	28	40	100
Princess	17.4	6.0	2.8	104	1119	80	30	-	30	26	28	28	-	100
Lord	7.2	5.9	2.7	42	452	-	-	-	-	-	-	14A / 16B	-	-
Marquis	6.0	4.7	2.7	28	301	-	-	-	-	-	-	8 A / 10B	-	-
Earl	6.0	4.7	2.8	28	301	-	-	-	-	-	-	5A / 8B	-	-
Count	6.5	5.9	2.8	38	409	-	-	-	-	-	-	14A / 16B	-	-
Baron	9.5	4.6	2.8	43	462	-	-	-	-	-	-	10A / 12B	-	-
Foyer I	6.5	3.4	3.8	22	236	-	-	-	-	-	-	-	-	20
Foyer II	6.0	3.5	2.8	21	226	-	-	-	-	-	-	-	-	20

A with screen
B without screen

Historical Rooms

First Floor

Sofitel Legend The Grand Amsterdam boasts no fewer than 19 meeting rooms and banqueting halls in total (covering 1400 sq.m.), 5 of which are listed as historical monuments and were taken into use when The Grand served as the Town Hall. All historical meeting rooms have natural daylight.



Main Building - First Floor

Marriage Chamber

The Marriage Chamber is located on the first floor of the monumental wing of The Grand and wasdesigned by artist Chris Lebeau, who completed this room in 1925. The Marriage Chamber is still used today as a location for weddings and private dinners. The wall paintings, with unique colour combinations, in this room symbolize the story of life. From the balcony of the Marriage Chamber you can overlook the beautiful inner garden of The Grand. The Marriage chamber provides an elegant setting with a harmonious ode to marriage and love.

- Stained glass windows that can be opened
- Adjoining balcony (24 m2)
- Air-conditioned

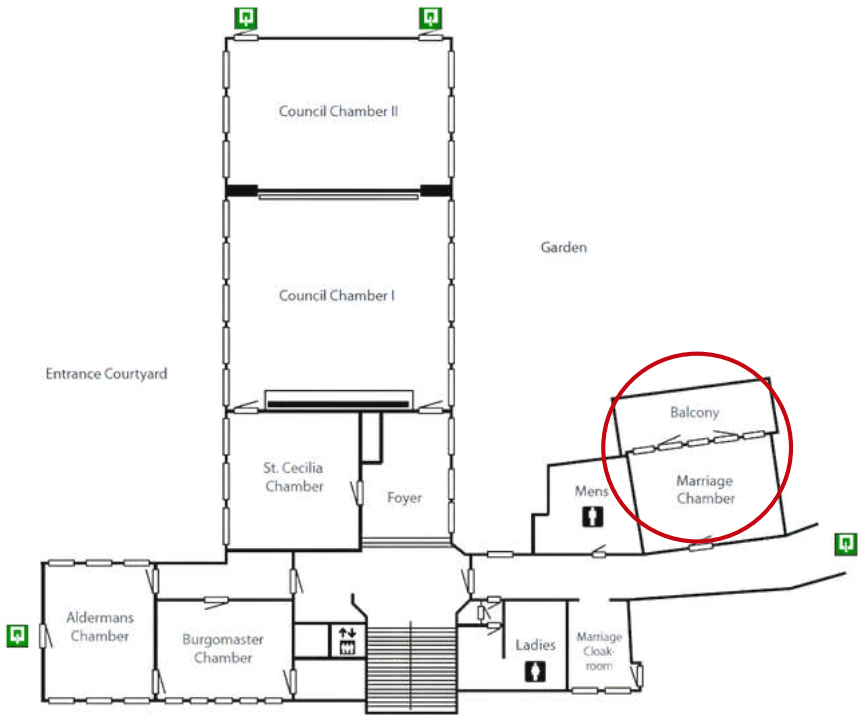

Dimensions and capacity

- Surface (m2 / ft2) 51 / 548
- Length (m) 8.0
- Width (m) 6.4
- Height (m) 3.2

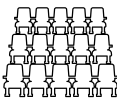

Theatre



Banquet



Boardroom



Cocktail

Marriage Chamber

45

20

20

40

Balcony

-

-

-

25

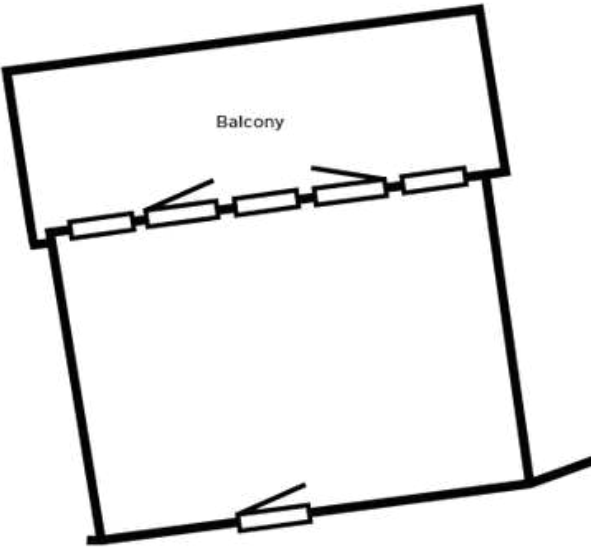

Main Building - First Floor

Council Chamber



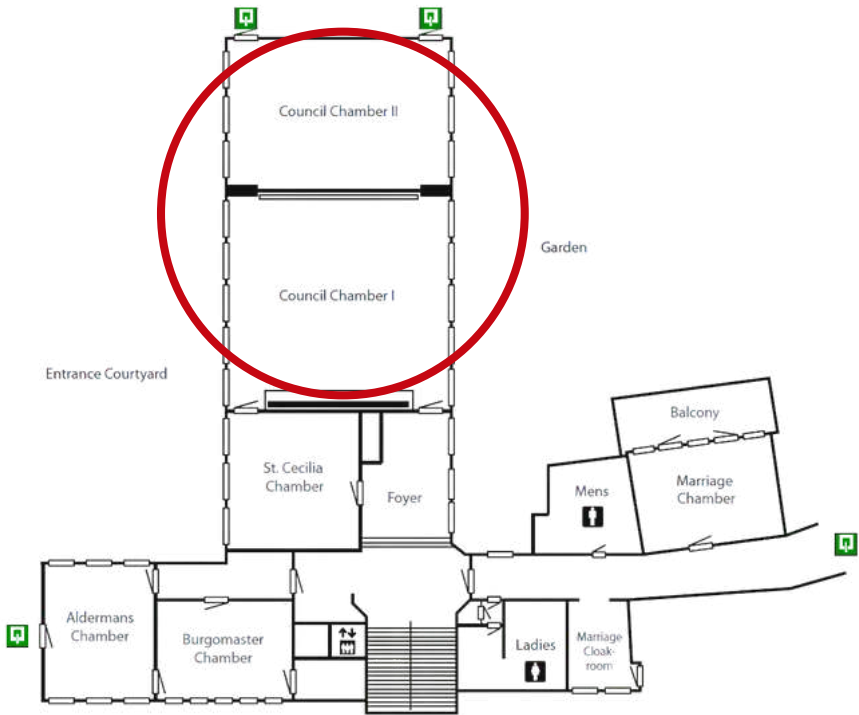

The Council Chamber was built in 1924 as the seat of Amsterdam's city council and is now listed as a historical monument. Designed in the expressive Amsterdam School style, the chamber is known for its collection of wooden sculptures by various renowned artists from that period, and chandeliers by versatile Dutch designer Frits Lensvelt. In this iconic setting, our former Queen, Princess Beatrix, was married in 1966.

- Beamer and built-in projection screen of 5,90 x 3,40 m
- Natural daylight
- Adjustable lightning and blinds
- Air-conditioned and windows that can be opened
- Fixed council table in front of the screen
- Wall-mounted speakers

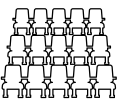
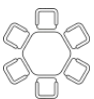

Dimensions and capacity

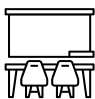
	Council Chamber		I	II
• Surface (m2 / ft2)	295 / 3175	177 / 3175	122 /1313	
• Length (m)	21.7	13.6	14.0	
• Width (m)	13.6	13.0	8.7	
• Height (m)	4.7	4.7	4.2	

	 Theatre	 Banquet	 Crescent	 Classroom	 Cocktail
Council Chamber	320	200	152	140	300
Council Chamber I	200	110	88	72	175
Council Chamber II	120	90	64	45	125

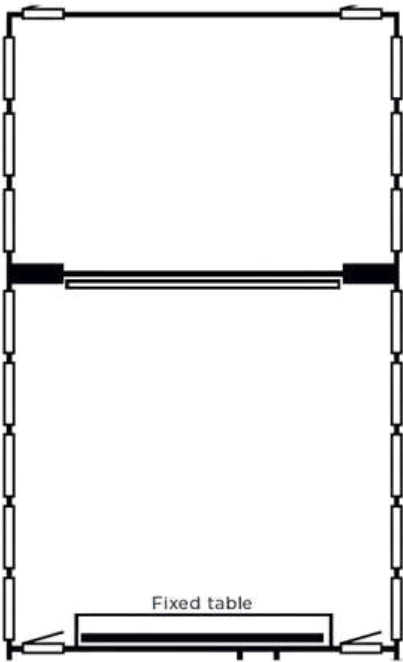

Main Building - First Floor

St. Cecilia Chamber

The St. Cecilia Chamber is one of the historical meeting rooms located on the first floor and overlooks the courtyard of The Grand. Previously used as the coffee room of the former city hall of Amsterdam, this square-shaped room is situated right next to the Council Chamber. Designed in the expressive Amsterdam School style, it features a remarkably high ceiling, historical wood-carved panels by Hildo Krop, and chandeliers by versatile Dutch designer Frits Lensvelt

- Natural daylight
- Adjustable lightning and blinds
- Air-conditioned and windows that can be opened

Dimensions and capacity

- Surface (m2 / ft2) 60 / 645
- Length (m) 8.0
- Width (m) 7.5
- Height (m) 5.0

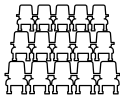

Theatre

50



Banquet

40



Crescent

21

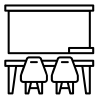

Classroom

27



Cocktail

60



Square

32



Boardroom

20

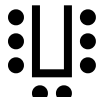

U-shape

24

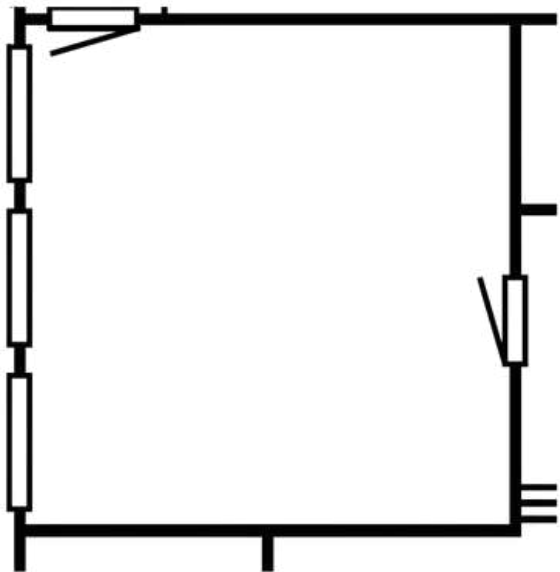
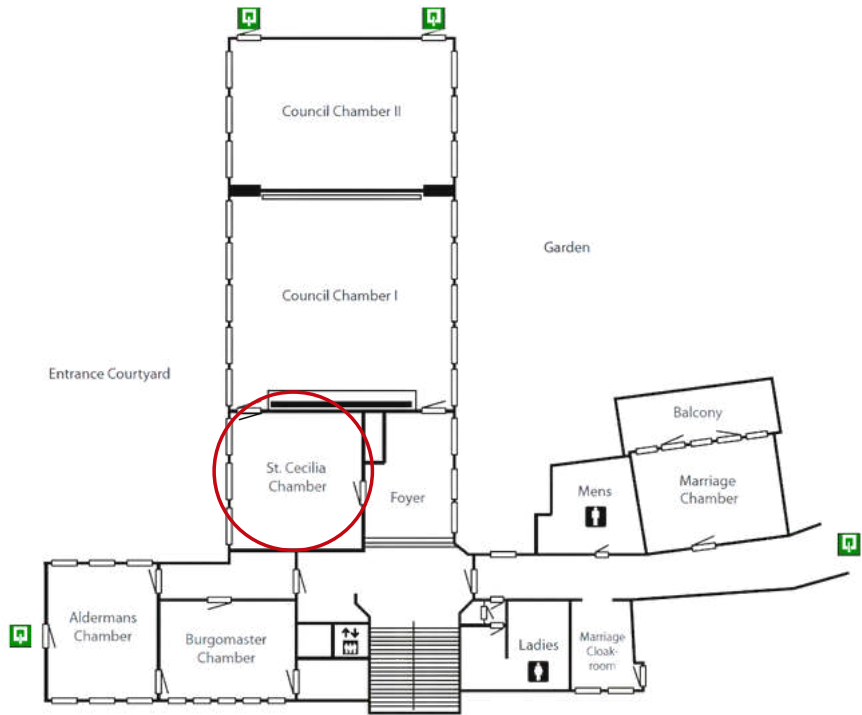

Main Building - First Floor

Aldermans Chamber

The stunning historical Aldermans Chamber was used, up until 1988, as the Mayor's meeting room. Designed in the characteristic Amsterdam School style, the room not only holds a unique place in the city's history but also features doors crafted by renowned artist Anton Fortuin. Along with its spectacular view over the oldest canals in Amsterdam, the chamber ensures your guests a unique and lasting impression of the city's architectural beauty.

- Natural daylight
- Adjustable lightning
- Air-conditioned and windows that can be opened

Dimensions and capacity

- Surface (m2 / ft2) 57 / 613
- Length (m) 8.1
- Width (m) 7.0
- Height (m) 3.0

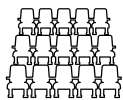

Theatre

40



Banquet

40

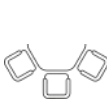

Crescent

21

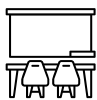

Classroom

24



Cocktail

60

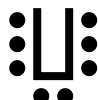

U-shape

24



Square

24



Boardroom

20

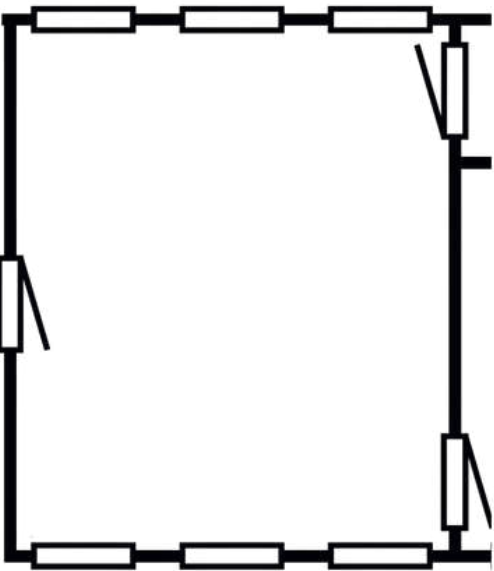
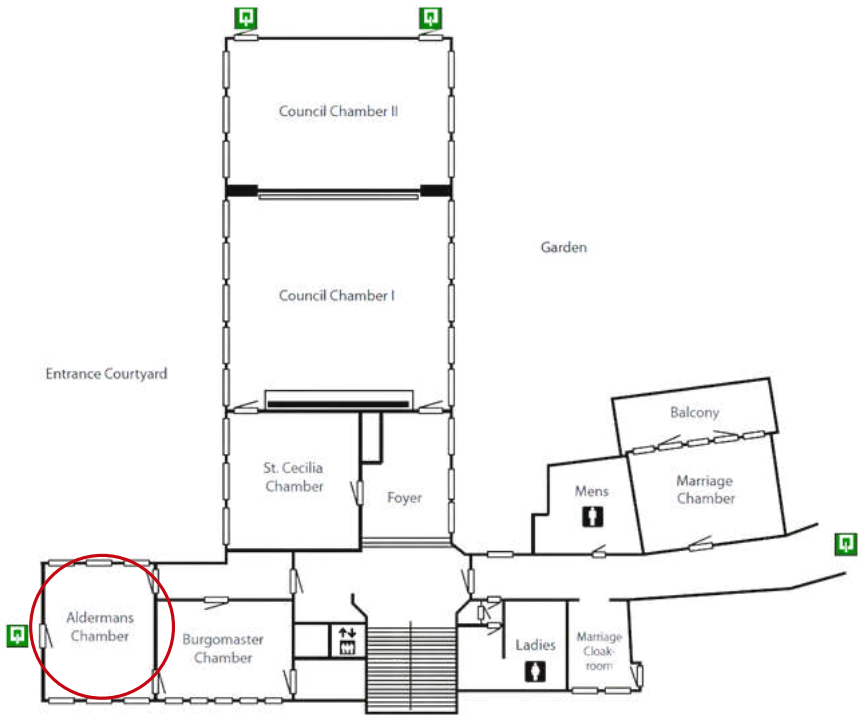

Main Building - First Floor

Burgomaster Chamber

Until 1988, the Burgomaster Chamber served as the office of the former mayors of Amsterdam. Designed in the expressive Amsterdam School style, the room offers a unique setting for meetings and private dinners, featuring doors crafted by renowned artist Anton Fortuin. The large windows provide a stunning view of the capital's oldest canals and its iconic Amsterdam canal houses.

- Natural daylight
- Adjustable lightning
- Air-conditioned and windows that can be opened

Dimensions and capacity

- Surface (m2 / ft2) 43 / 462
- Length (m) 8.2
- Width (m) 5.3
- Height (m) 3.0

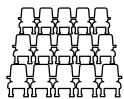

Theatre

30



Banquet

30



Boardroom

20



Classroom

18



Cocktail

60

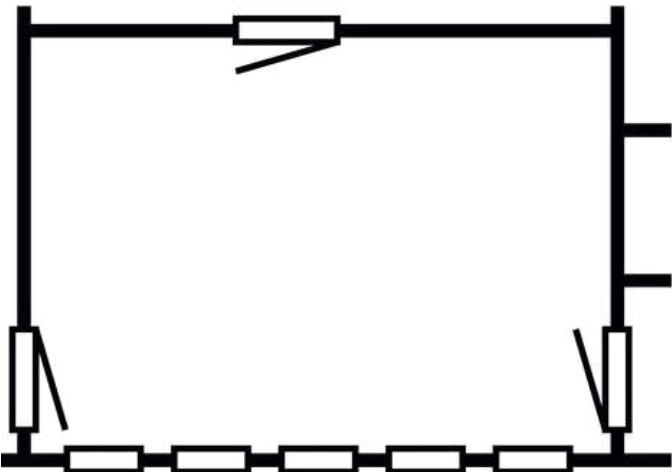

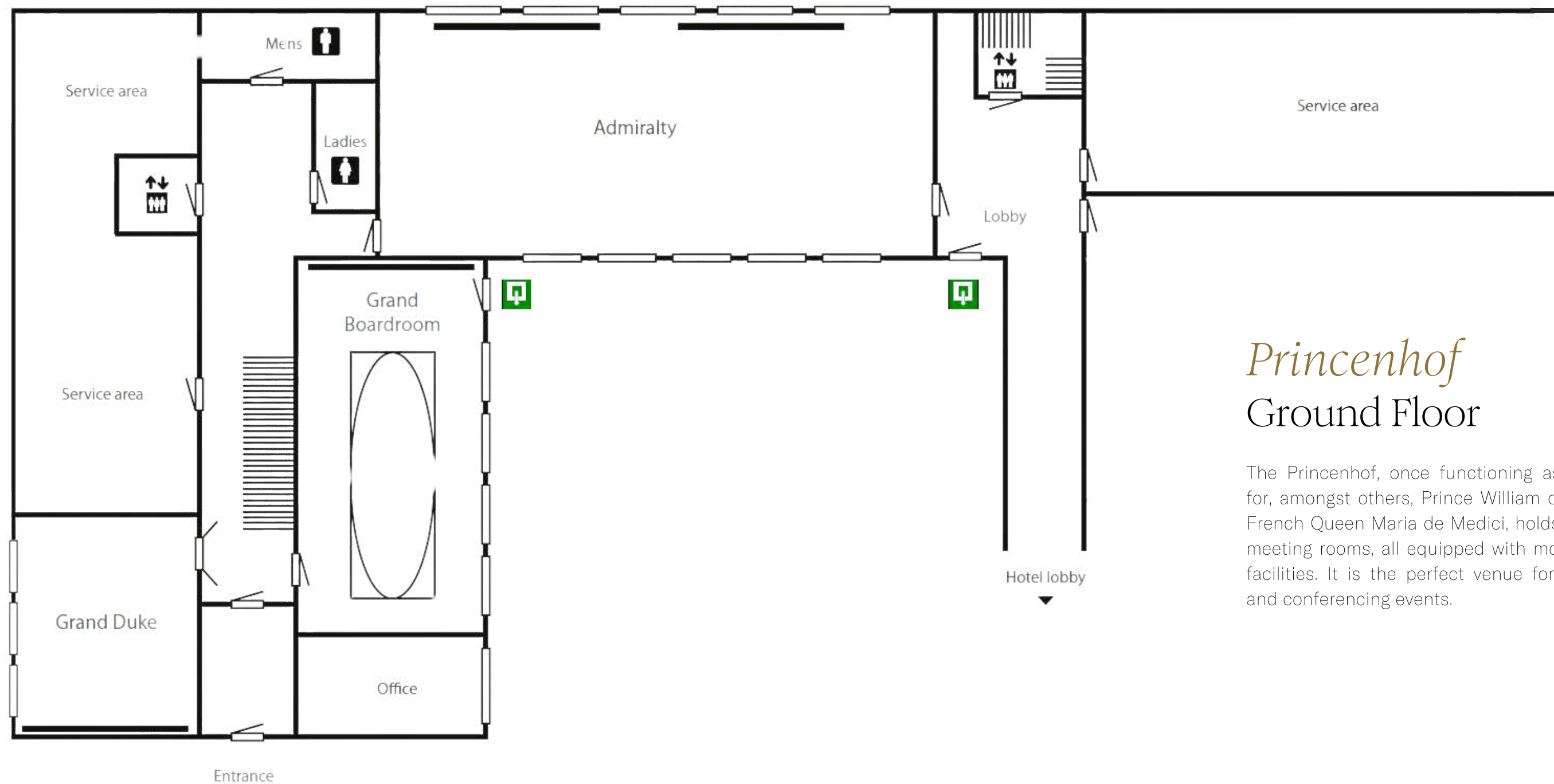

Princenhof Ground Floor

The Princenhof, once functioning as accommodation for, amongst others, Prince William of Orange and the French Queen Maria de Medici, holds 14 contemporary meeting rooms, all equipped with modern audio-visual facilities. It is the perfect venue for private meetings and conferencing events.

Princenhof - Ground Floor

Admiralty

The Admiralty is located on the ground floor of the Princenhof. The room displays a stylish palette of grey and pink colours and has high windows, from which you can see the courtyard of The Grand and the breathtaking hotel facade. The Admiralty is designed to cater lunch/dinner up to 100 people and exclusive standing receptions up to 150 guests. During summer, the Admiralty can be combined with the courtyard of The Grand.

- 3 built-in projectors and projection screens of 2,40 x 1,75 m
- Built-in audio system
- Natural daylight
- Adjustable lightning and blinds
- Air-conditioned

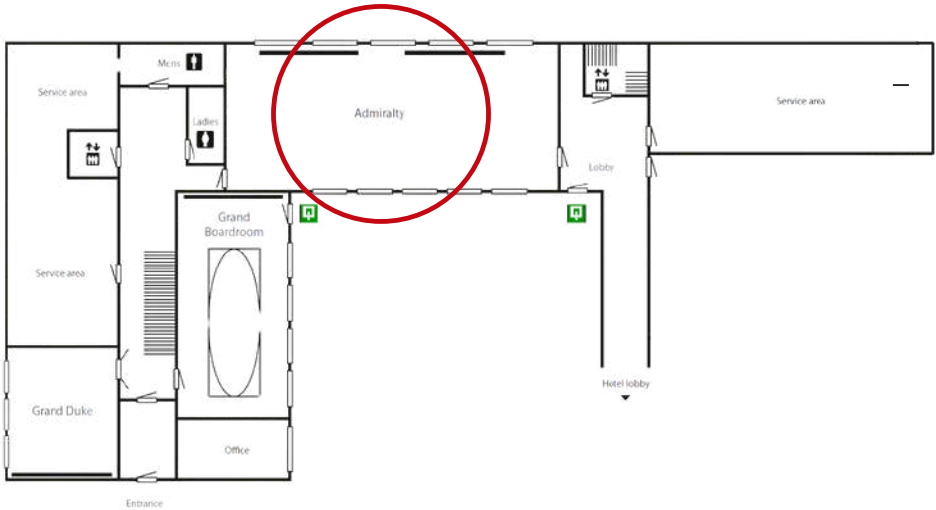

Dimensions and capacity

- Surface (m2 / ft2) 144 / 1550
- Length (m) 19.0
- Width (m) 7.6
- Height (m) 3.7

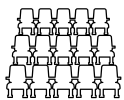

Theatre

110



Banquet

100



Crescent

56



Boardroom

40



Cocktail

150

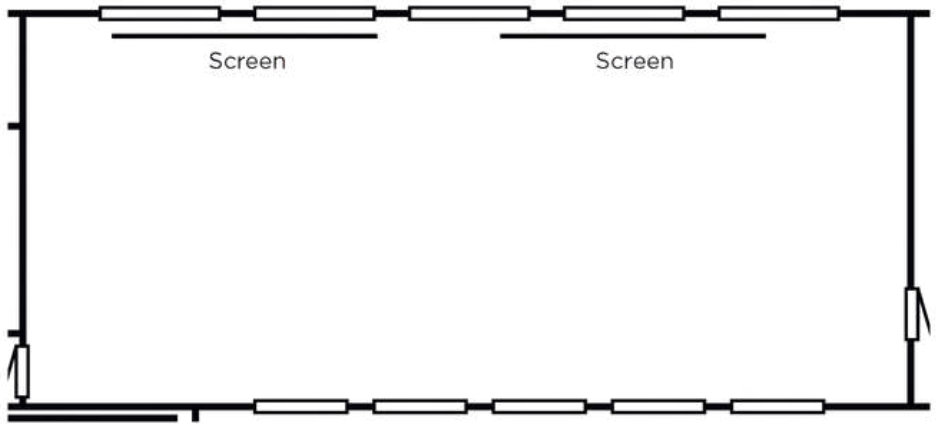

Princenhof - Ground Floor

Grand Boardroom

The Grand Boardroom is a modern meeting facility that features contemporary comfort combined with the latest technology, such as built-in audiovisual equipment. The spacious Grand Boardroom overlooks the historical courtyard of The Grand and can be combined with the Grand Duke as a private catering location. The Grand Boardroom offers the perfect combination of a rich historical setting with French Art de Vivre style.

- Built-in projection screen of 2,40 x 1,75 m
- Natural daylight
- Adjustable lightning and blinds
- Air-conditioned and windows that can be opened
- Power socket, HDMI and internet access integrated in the table
- Soundproof

Dimensions and capacity

- Surface (m2 / ft2) 56 / 602
- Length (m) 9.7
- Width (m) 5.8
- Height (m) 4.2



Boardroom

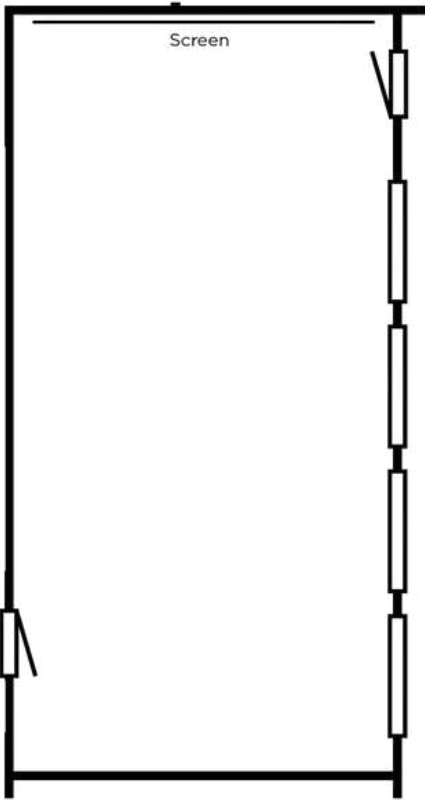
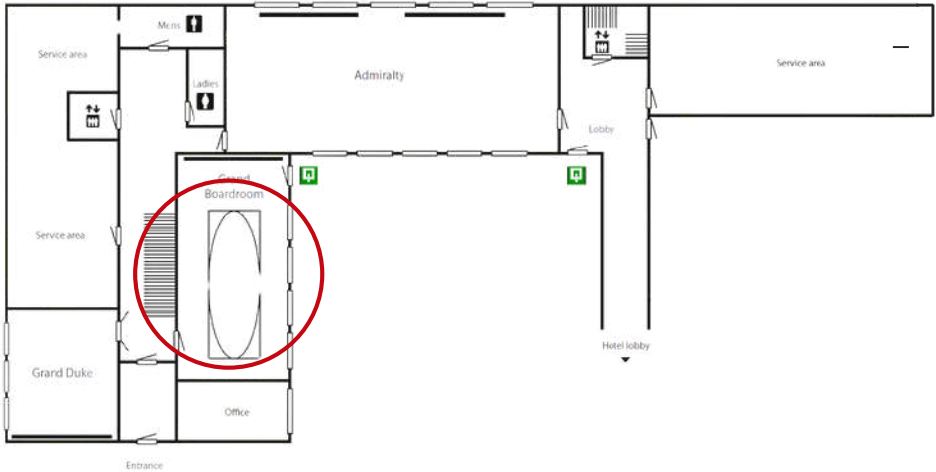

Princenhof - Ground Floor

Grand Duke

The Grand Duke is located on the ground floor, next to the imposing entrance of the Princenhof. The room has large windows to ensure natural daylight and overlooks one of Amsterdam's most beautiful canals with typical Amsterdam canal houses.

- Built-in projector and projection screen of 2,40 x 1,75 m
- Built-in audio system
- Natural daylight
- Adjustable lightning and curtains
- Air-conditioned

Dimensions and capacity

- Surface (m2 / ft2) 39 / 419
- Length (m) 6.7
- Width (m) 5.9
- Height (m) 3.6

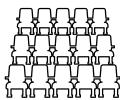

Theatre

30



Banquet

20

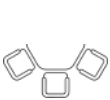

Crescent

14

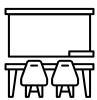

Classroom

12



Cocktail

30

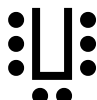

U-shape

12



Square

16



Boardroom

12

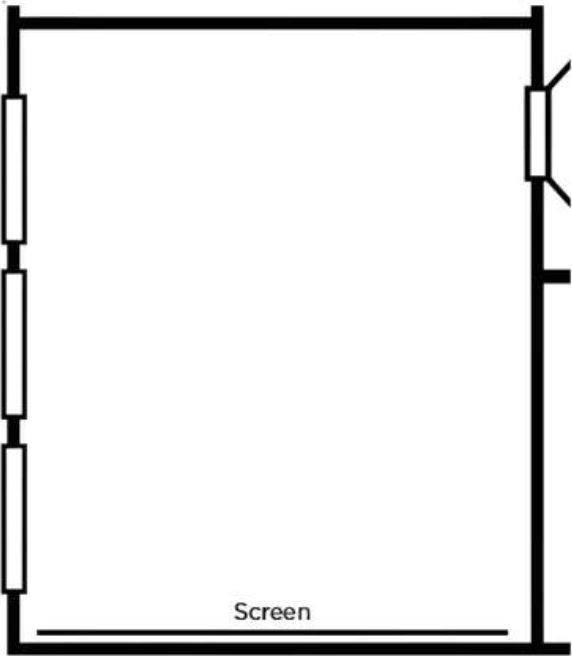
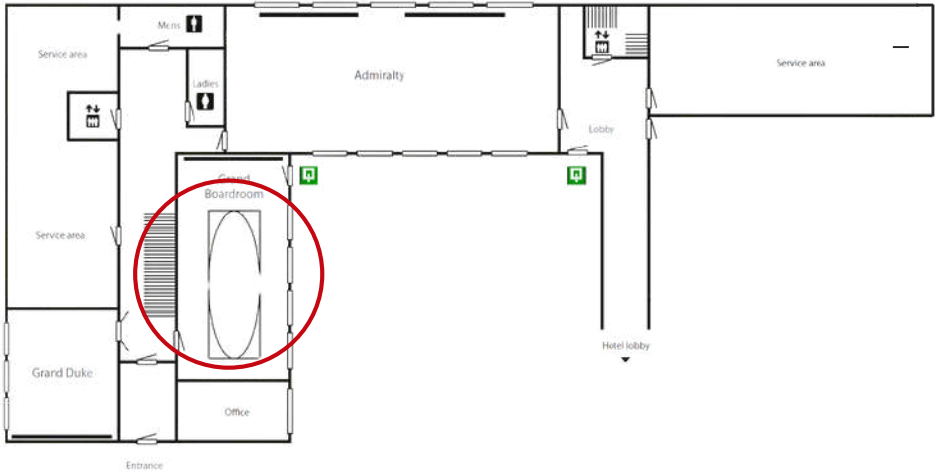



Princenhof First Floor

The Princenhof, once functioning as accommodation for, amongst others, Prince William of Orange and the French Queen Maria de Medici, holds 14 contemporary meeting rooms, all equipped with modern audio-visual facilities. It is the perfect venue for private meetings and conferencing events.

Princenhof - First Floor

King

The King is located on the first floor of the beautiful Princenhof. This spacious modern meeting room is equipped with all the necessary modern comfort and audiovisual equipment. It is located on the exact opposite of the Queen, separated by a foyer. The King has large windows ensuring natural daylight and providing a unique view over the Amsterdam canals. Additionally, the King boasts wonderful high ceilings and can accommodate a maximum of 80 guests in theatre setup.

- Built-in projector and projection screen of 3,00 x 2,25 m
- Built-in audio system
- Natural daylight
- Adjustable lightning and blinds
- Air-conditioned

Dimensions and capacity

- Surface (m2 / ft2) 94 / 1011
- Length (m) 15.2
- Width (m) 6.2
- Height (m) 3.8



Cocktail

100

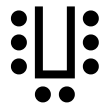

U-shape

32

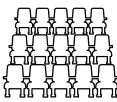

Theatre

80



Banquet

48



Square

26



Boardroom

28



Crescent

30

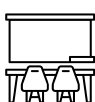

Classroom

30

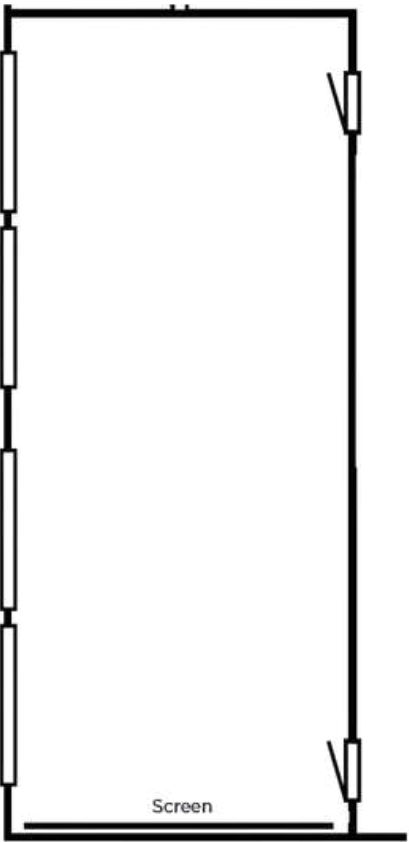
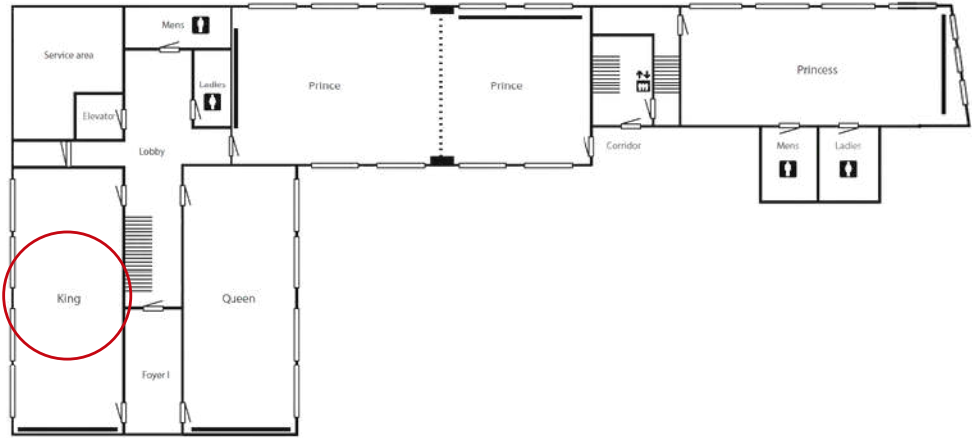

Queen

The Queen is located on the first floor of the Princenhof. This spacious and bright meeting room is equipped with all the necessary modern comfort and audiovisual equipment. It is located on the exactly opposite side of the King, separated by a foyer. The Queen has a wonderful view over the Amsterdam canals, boasts high ceilings and can accommodate a maximum of 80 guests in theatre setup.

- Built-in projector and screen of 3,00 x 2,25 m
- Built-in audio system
- Natural daylight
- Adjustable lightning and blinds
- Air-conditioned

Dimensions and capacity

- Surface (m2 / ft2) 85 / 914
- Length (m) 13.8
- Width (m) 6.2
- Height (m) 3.2



Cocktail

100

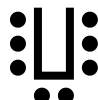

U-shape

32

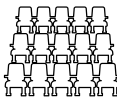

Theatre

80



Banquet

48



Square

26



Boardroom

28

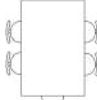

Cabaret

5 pax

30

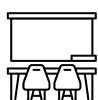

Classroom

30

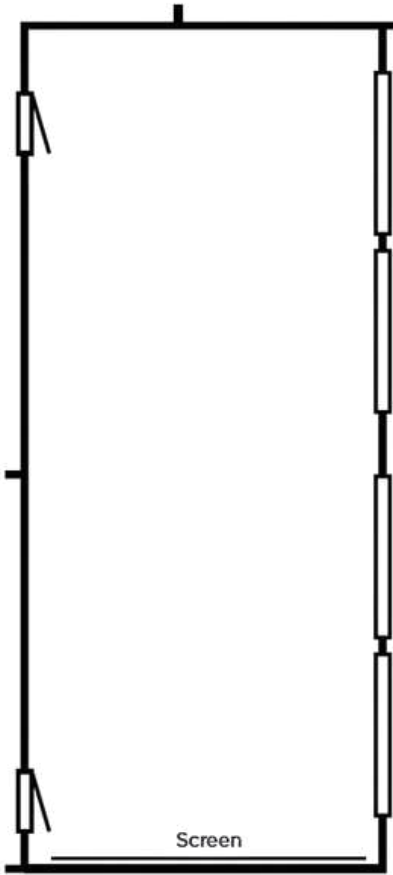
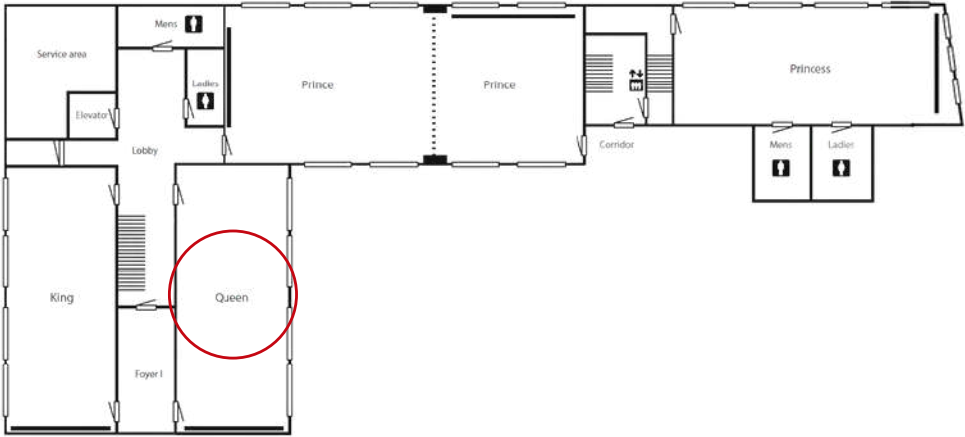

Princenhof - First Floor

Princess

The Princess is a spacious room, located on the first floor of the Princenhof. The room is equipped with all the necessary modern comforts and has private bathroom facilities. The Princess overlooks the Amsterdam canals and offers a lot of natural daylight because of the large windows on two sides of the room.

- Built-in projector and screen of 2,90 x 1,80 m
- Built-in audio system
- Natural daylight
- Adjustable lightning and blinds
- Air-conditioned

Dimensions and capacity

- Surface (m2 / ft2) 104 / 1119
- Length (m) 17.4
- Width (m) 6.0
- Height (m) 2.8

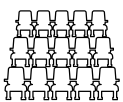

Theatre

80

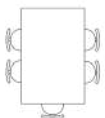

Cabaret
5 pax

30

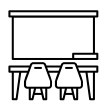

Classroom

30



Cocktail

100



Square

26



Boardroom

28

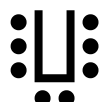

U-shape

28

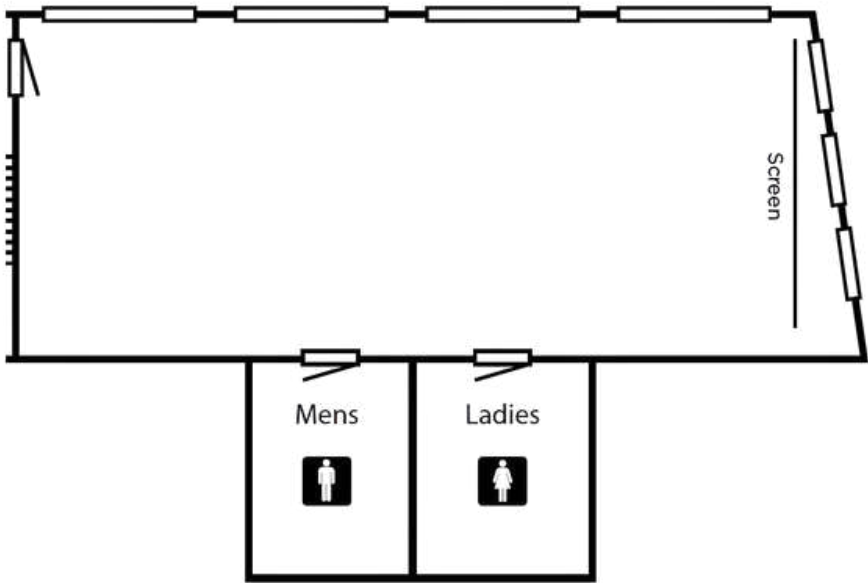
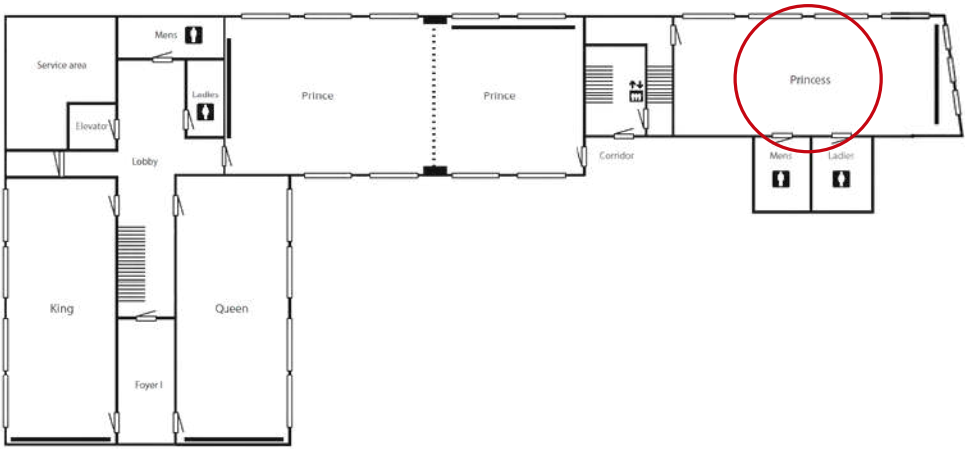

Princenhof - First Floor

Prince

The Prince is situated on the first floor of the Princenhof and fitted with built-in audio-visual equipment. The Prince overlooks the courtyard of The Grand and can be divided into two separate rooms by a sliding wall. Prince I has a total of 90.4 m2 and Prince II a total of 64.6 m2.

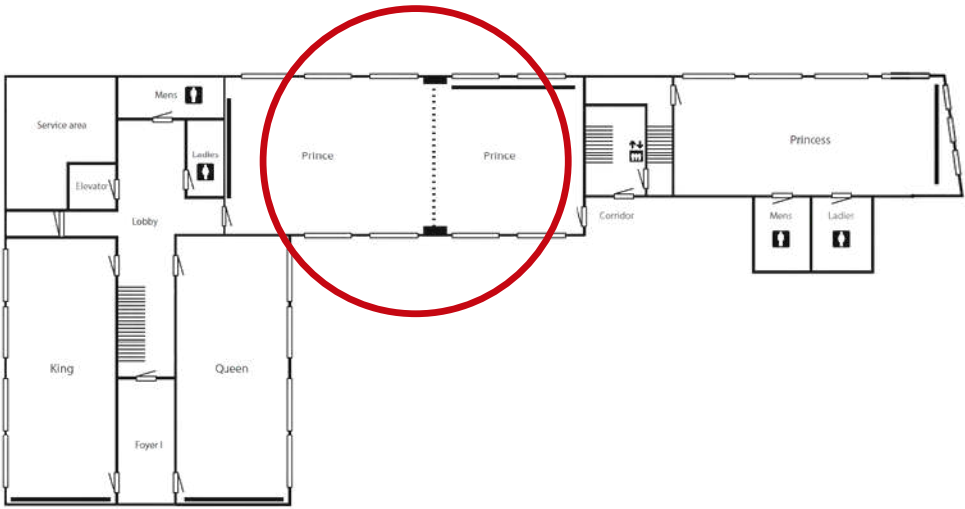

Dimensions and capacity

- Surface (m2 / ft2) 155 / 1668
- Length (m) 19.4
- Width (m) 8.0
- Height (m) 3.3

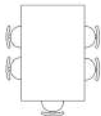
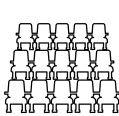

Theatre

Cabaret
5 pax

Prince I
Prince II

100
50

45
30



Square

Boardroom

U-shape

Banquet

Classroom

Cocktail

Prince I	36	30	32	50	45	90
Prince II	24	10	16	30	27	60

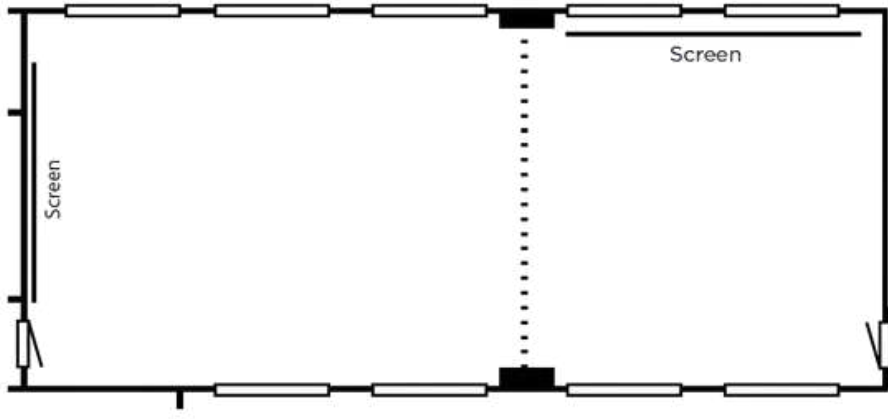



Princenhof Second Floor

The Princenhof, once functioning as accommodation for, amongst others, Prince William of Orange and the French Queen Maria de Medici, holds 14 contemporary meeting rooms, all equipped with modern audio-visual facilities. It is the perfect venue for private meetings and conferencing events.

Princenhof - Second Floor

Earl

The Earl is a boardroom with fixed setup on the second floor of the Princenhof. It has a central control panel that enables guests to control the lights, air conditioning, etc in the room. The Earl can easily be combined with the other boardrooms on the floor.

- Built-in 52" HD plasma screen
- Natural daylight
- Adjustable lightning and curtains
- Air-conditioned
- Power socket, VGA and internet access integrated in the table



Dimensions and capacity

- Surface (m2 / ft2) 28 / 301
- Length (m) 6.0
- Width (m) 4.7
- Height (m) 2.8



Boardroom

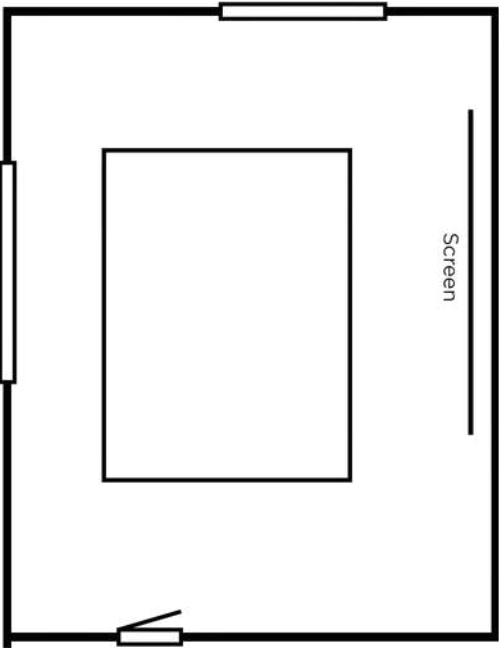

5 with screen
8 without screen

Count

The Count is a boardroom with fixed setup on the second floor of the Princenhof. It has a central control panel that enables guests to control the lights, air conditioning, etc in the room. The Count can easily be combined with the other boardrooms on the floor.

- Built-in 75" HD plasma screen
- Natural daylight
- Adjustable lightning and curtains
- Air-conditioned
- Power socket, HDMI and internet access integrated in the table



Dimensions and capacity

- Surface (m2 / ft2) 38 / 409
- Length (m) 6.5
- Width (m) 5.9
- Height (m) 2.8



Boardroom

14 with screen
16 without screen

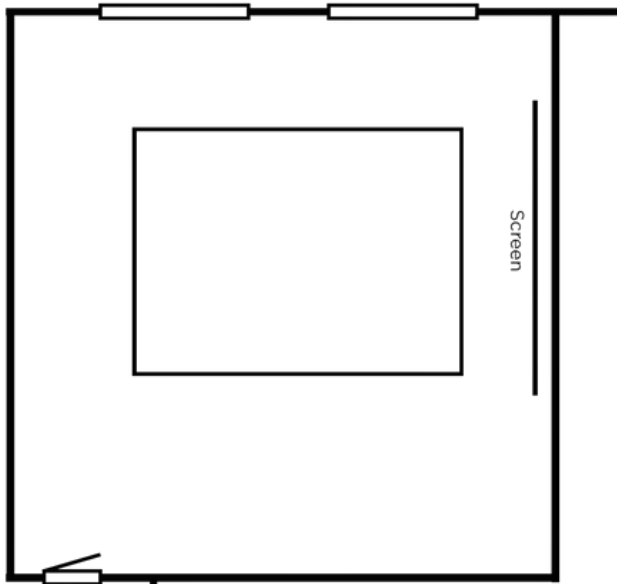

Princenhof - Second Floor

Baron

The Baron is a boardroom with fixed setup on the second floor of the Princenhof. It has a comfortable lounge area next to the boardroom table.

- Built-in 85" HD plasma screen
- Natural daylight
- Adjustable lightning
- Air-conditioned
- Power socket, HDMI and internet access integrated in the table
- Separate lounge area inside the meeting room



Dimensions and capacity

- Surface (m2 / ft2) 43 / 462
- Length (m) 9.5
- Width (m) 4.6
- Height (m) 2.8



Boardroom

10 with screen
12 without screen

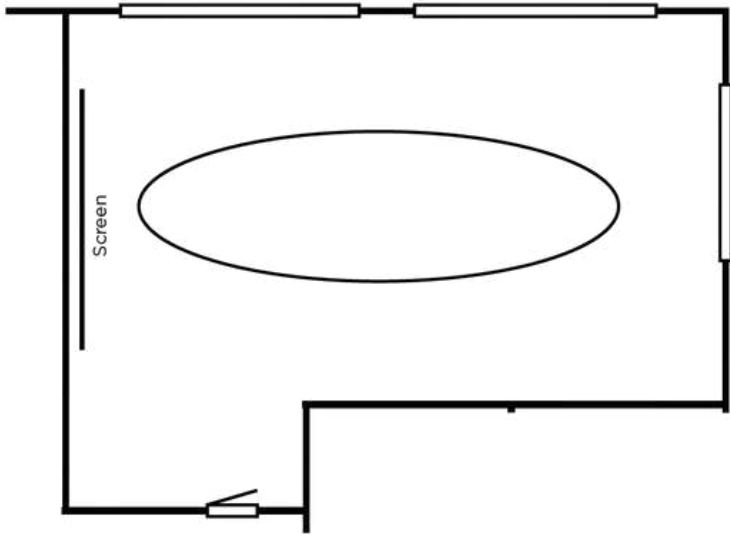

Princenhof - Second Floor

Marquis

The Marquis is a boardroom with fixed setup on the second floor of the Princenhof. It has a central control panel that enables guests to control the lights, air-conditioning, etc in the the room. The Marquis can easily be combined with the other boardrooms on the floor.

- Built-in 52" HD plasma screen
- Natural daylight
- Adjustable lightning and curtains
- Air-conditioned
- Power socket, VGA and internet access integrated in the table



Dimensions and capacity

- Surface (m2 / ft2) 28 / 301
- Length (m) 6.0
- Width (m) 4.7
- Height (m) 2.7



Boardroom

8 with screen
10 without screen

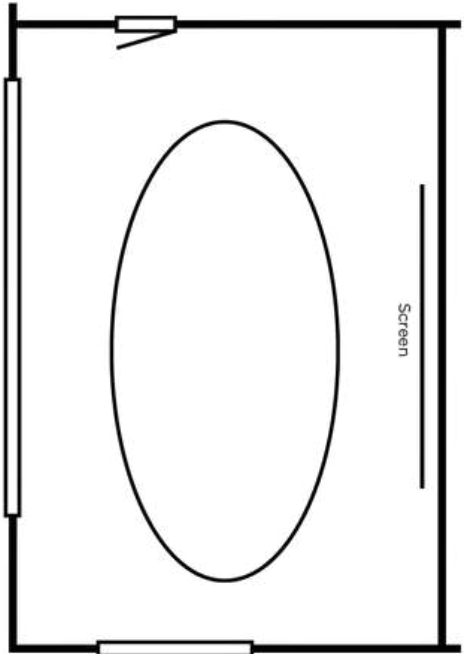

Princenhof - Second Floor

Lord

The Lord is a boardroom with fixed setup on the second floor of the Princenhof. It has a central control panel that enables guests to control the lights, air-conditioning, etc in the room. The Lord can easily be combined with the other boardrooms on the floor.

- Built-in 75" HD plasma screen
- Natural daylight
- Adjustable lightning and curtains
- Air-conditioned
- Power socket, HDMI and internet access integrated in the table

Dimensions and capacity

- Surface (m2 / ft2) 42 / 452
- Length (m) 7.2
- Width (m) 5.9
- Height (m) 2.7



Boardroom

14 with screen
16 without screen

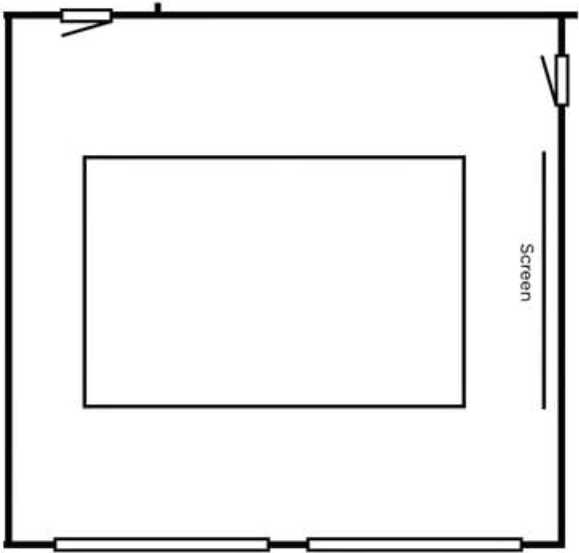



THE GRAND
AMSTERDAM • 1578



SOFITEL LEGEND THE GRAND AMSTERDAM

OUDEZIJDS VOORBURG WAL 197
1012EX - AMSTERDAM - THE NETHERLANDS
TEL. +31 (0)20 555 3 339
MEETINGS.THEGRAND@SOFITEL.COM
WWW.SOFITEL-LEGEND-THEGRAND.COM

